

Multiple-Choice

Last Modified on 03/25/2026 3:16 am EDT

The Multiple-Choice Module is used to create multiple-choice questions.

Hide All Answers

Getting Started

1. To insert the Multiple-Choice Module in to the Question Text section, click the multiple-choice button in the Question Type Palette. The symbol on this button is a rectangle that contains two circles and two lines.

Question Text*

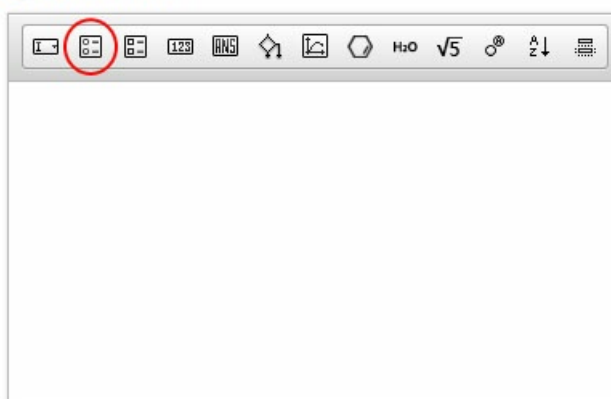

2. Once inserted into the Question text section, the module will always appear as a question stem and four blank multiple-choice options, as exemplified in the screenshot below:

Question Text*

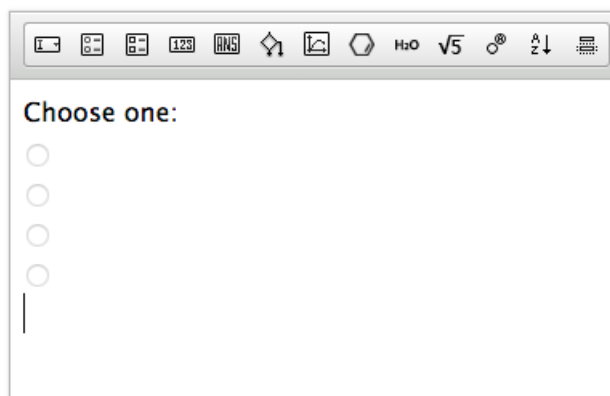

As answer choices are added to the Module editor, they will populate the module that appears in the Question text section.

3. To open the Multiple-Choice Module editor, double click on the module.

The Multiple-Choice Module Editor consists of two tabs: an Options tab, in which you write the answer options, and a Feedback tab, in which you write the feedback students will see when they select each of the answer options.

Multiple-choice

Options
Feedback

Media Palette
Text Formatting Palette
Feedback Formatting Palette

Editable Text Field

Is Answer?

Check this if the lettered tab contains the correct answer

Save
Cancel
 Scramble answer choices

Text Editor

Each Answer Choice tab contains a text editor, which allows you to add text and other multimedia to the answer options.

Important Note: Copying and pasting text from a Word Document into Smartwork5 could insert formatting that will corrupt the module. Please enter the text directly into the Text Editor, or copy and paste from a plain text document.

The Media Palette allows you to insert multimedia as answer options.



From left to right, the Media Palette allows you to do the following:

- Insert chemical equations
- Insert symbolic (math) equations
- Insert algorithmic variables
- Insert image files
- Insert music files
- Insert video files
- Insert hyperlinks
- Remove the hyperlinks

The Text Formatting Palette allows you to format text, as well as add special characters.



From left to right, the Text Formatting Palette allows you to do the following:

- Bold text
- Italicize text
- Underline text
- Insert subscripts
- Insert superscripts
- Insert math formulas *This button is being phased out. To insert math equations, use the symbolic equation editor.
- Insert special characters
- Remove any formatting applied to the text

Furthermore, the Feedback Formatting Palette allows you to do the following:



- Insert tables
- Insert line breaks
- Edit text in full screen mode

To set up a question, do the following:

1. In Answer Choice tab A, type out one of the answer choices you would like to include in the module. Format the text and insert any multimedia you see fit.
2. In Answer Choice tab B, type out another answer choice you would like to include in the module.
3. Repeat until all of the answer choices are in the module. Add and subtract Answer Choice tabs as needed.
4. At the bottom of the tab with the correct answer choice, check the box that says “Is Answer?”
5. Save the question.

Creating Feedback

The Feedback tab allows you to write feedback that students will see when they select an answer choice.

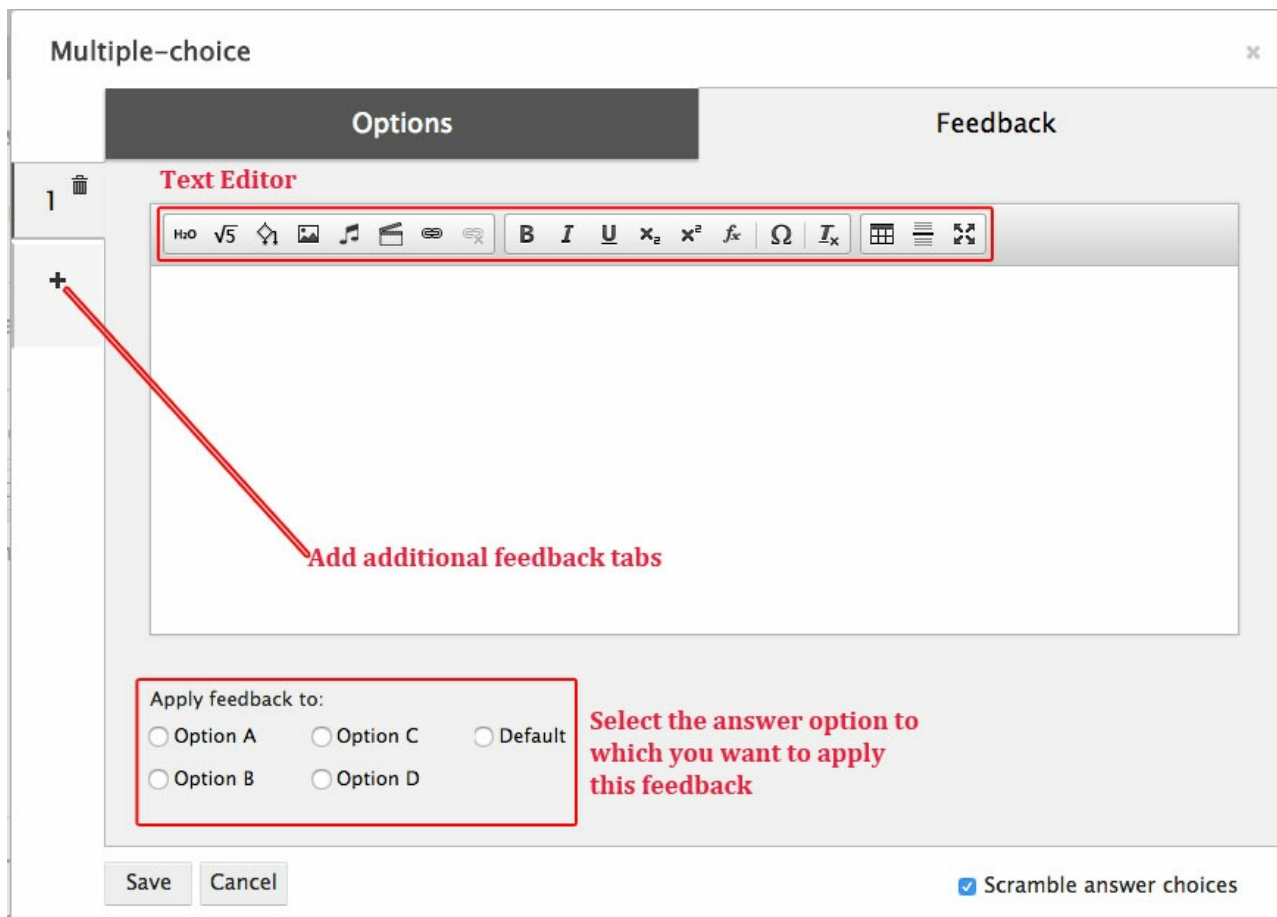

This tab contains many of the same elements as the Options tab, such as the Text Editor, and the ability to add or delete tabs by respectively clicking on the + tab and the trashcan.

Linking Feedback to an Answer Option

At the bottom of each tab is a section that allows you to select the answer option to which the feedback should correspond.

There are a few things you should keep in mind when linking feedback to answer options:

1. The correct answer option will always have a checkmark next to it. It is good practice to set feedback for the correct answer first.
2. A student will see the Default feedback under two circumstances: (a) If she does not submit an answer choice and (b) if the author does not write feedback for a specific incorrect answer choice. It is good practice to set default feedback second.
3. If you write default feedback, you do not have to write feedback for every incorrect answer option. However, check with your editor for best practices.
4. You can only link one set of feedback to one answer options.

Steps to Create Feedback

To create feedback, do the following:

1. In the bottom left-hand corner of the first Feedback tab, select the Answer Option to which you would like to apply feedback.
2. Type out the feedback you would like students to see when they select that option.

Multiple-choice ×

Options

Feedback

1+

H₂O √5 ∫ 📷 🎵 📄 🔗 🗨️ **B** *I* U x₂ x² f_x Ω I_x 📊 ☰ 🔄

Correct! Lady Mary Crawley is a character on the hit television show *Downton Abbey*.

Apply feedback to:

Option A ✓ Option C Default

Option B Option D

Save Cancel Scramble answer choices

3. Repeat this for as many options as you see fit, taking care to create feedback for the correct answer and to create the Default feedback.
4. Save the module.
5. Go to preview mode in the Question Editor. Check that the feedback is working correctly by selecting each of the answers and clicking "Check Answer."

> Solution

Feedback

1st attempt

✓ Correct

Correct! Lady Mary Crawley is a character on the hit television show *Downton Abbey*.

Fe

W

✓ Choose one:

- A. Jane Bingley
- B. Lady Mary Crawley
- C. Lady Catherine de Borugh
- D. Mr. Darcy